

STARTING SYSTEM

NKS000SC

Removal and Installation 2WD MODELS

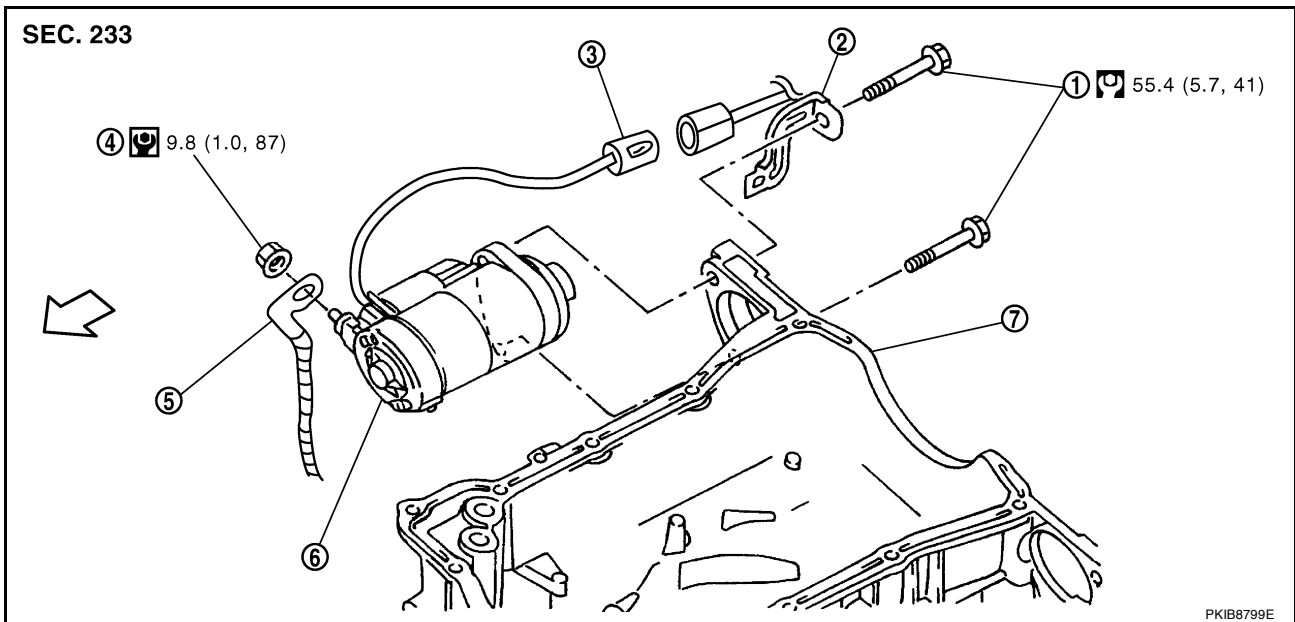

1. Starter motor mounting bolt

2. Harness clip bracket

3. S connector

4. B terminal nut

5. B terminal harness

6. Starter motor

7. Oil pan

: N·m (kg·m, ft·lb)

: N·m (kg·m, in·lb)

: Engine front

Removal

1. Disconnect the battery cable from the negative terminal.
2. Remove engine rear undercover, using power tools.
3. Disconnect "S" connector.
4. Remove "B" terminal nut.
5. Remove starter motor mounting bolts and harness connector clip bracket, using power tools.
6. Remove starter motor downward.

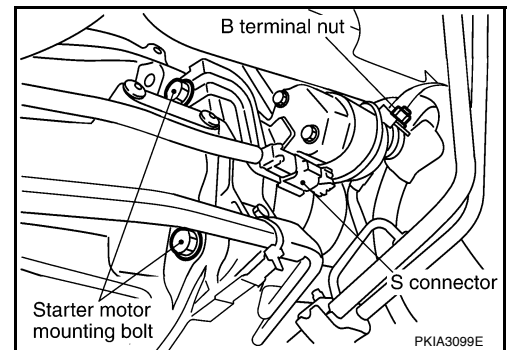

Installation

Installation is the reverse order of removal.

CAUTION:

Be sure to tighten "B" terminal nut carefully.